

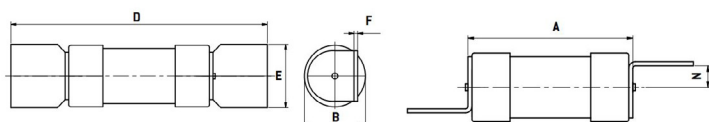

### AC3315

### 32A NS Fuse

550V AC 80kA / 250V DC 40kA, Overall length, H:61mm / Diameter: 13.5mm (Size F1)



Technical Specification	
Voltage (AC/DC)	550/250
Rating	32A
Breaking Capacity	40 kA
Dimensions (mm)	35.5 (A) 13.5 (B) 61 (D) 12.7 (E) 0.8 (F) 3.5 (N)
Pre Arcing I <sup>2</sup> T (AMPERE <sup>2</sup> SECONDS)	670
Total I <sup>2</sup> T (AMPERE <sup>2</sup> SECONDS)	3350
Watt Loss	2.9
Curve Type	gG

3-AC3315-2021-V1